

REVISIONS			
REV	DESCRIPTION	DATE	APPROVED
--	--	--	--

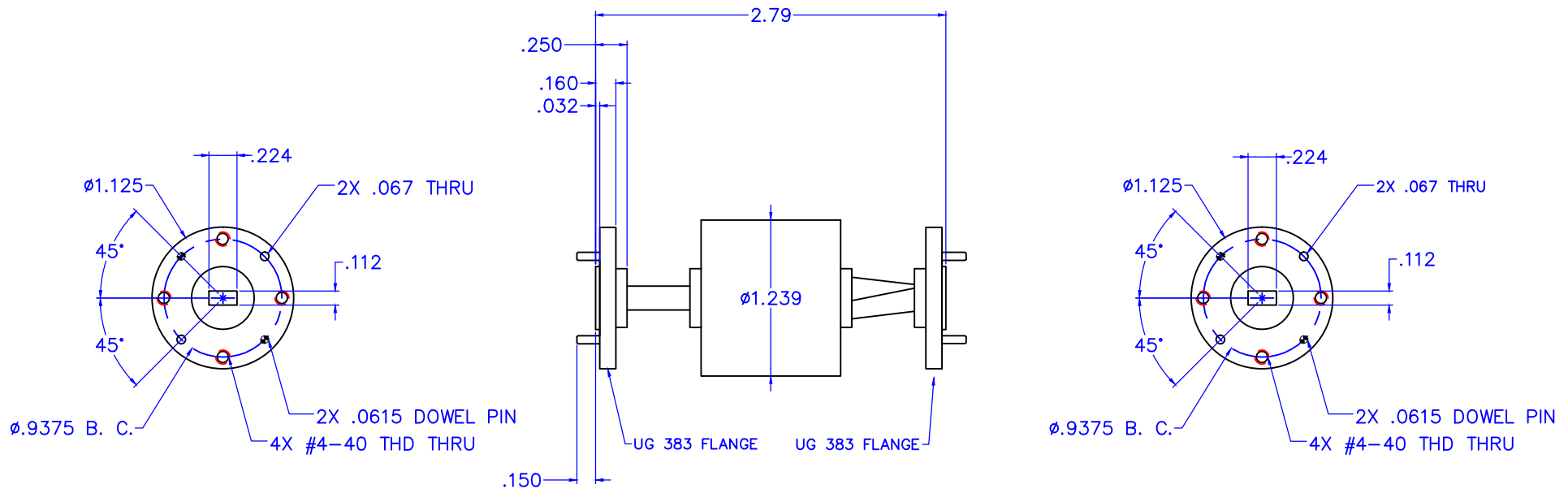

ALL SURFACES $\sqrt{32}$ UNLESS OTHERWISE SPECIFIED DIMENSIONS ARE IN INCHES TOLERANCES ARE: DECIMALS: .1234 +/- .0005 .123 +/- .005 .12 +/- .01 ANGLES: +/- .5 DEGREES ALL THREADS TO BE 2A OR 2B REF DWG#: --	THIRD ANGLE PROJECTION		Millimeter Products Inc.	
			TITLE 115B/383 OUTLINE	
	DRAFTING: MRN APPROVED: M.S. DATE: 7/31/2019		SIZE A	DWG NO 21714
	SHEET NO. 1	OF 1		