

REVISIONS			
REV	DESCRIPTION	DATE	APPROVED
--	--	--	--

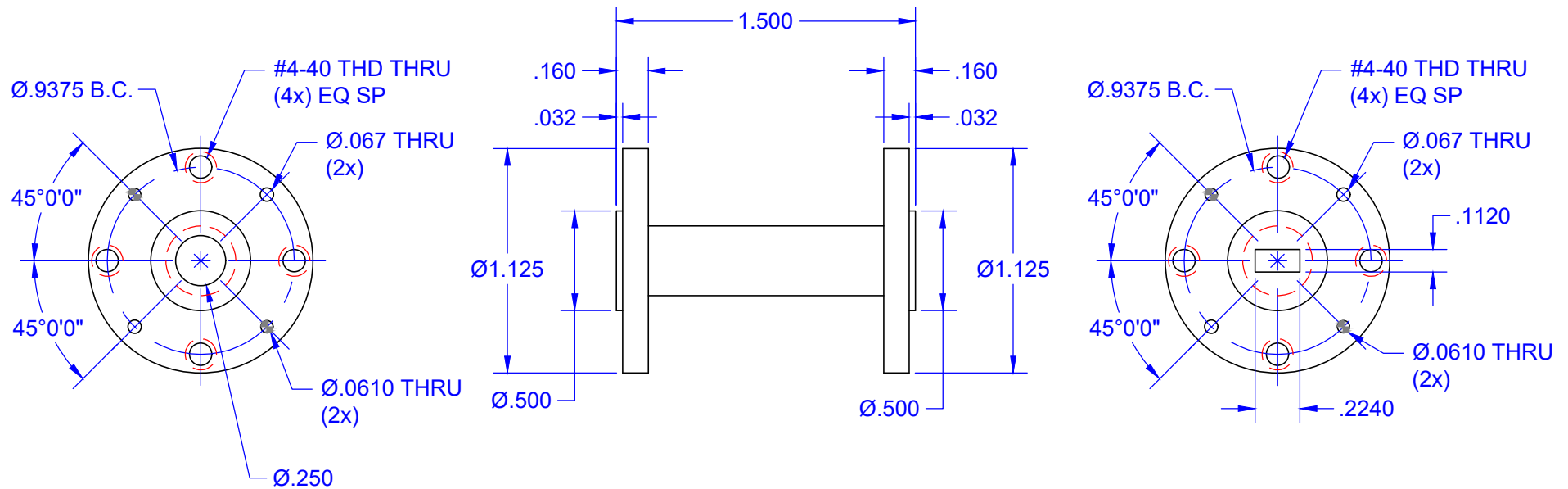

FREQUENCY RANGE (GHz)	CIRCULAR WAVEGUIDE PORT DIAMETER (IN.)
43-50	0.188
38.5-43	0.219
33-38.5	0.250

QTY	PART NUMBER	MATERIAL: 1/2 HARD BRASS		DESCRIPTION	ITEM
UNLESS OTHERWISE SPECIFIED				Mi-Wave Millimeter Products Inc.	
ALL SURFACES $\sqrt{32}$					
DIMENSIONS ARE IN INCHES TOLERANCES ARE: DECIMALS: .1234 +/- .0005 .123 +/- .005 .12 +/- .01 ANGLES: +/- .5 DEGREES		THIRD ANGLE PROJECTION		TITLE	
		DRAFTING: JV		284B-383 OUTLINE	
		APPROVED: M.S.			
		DATE: 2-27-14			
ALL THREADS TO BE 2A OR 2B		SHEET NO.	OF	SIZE	DWG NO
REF DWG# --		1	1	A	25863