

REVISIONS			
REV	DESCRIPTION	DATE	APPROVED
--	--	--	--

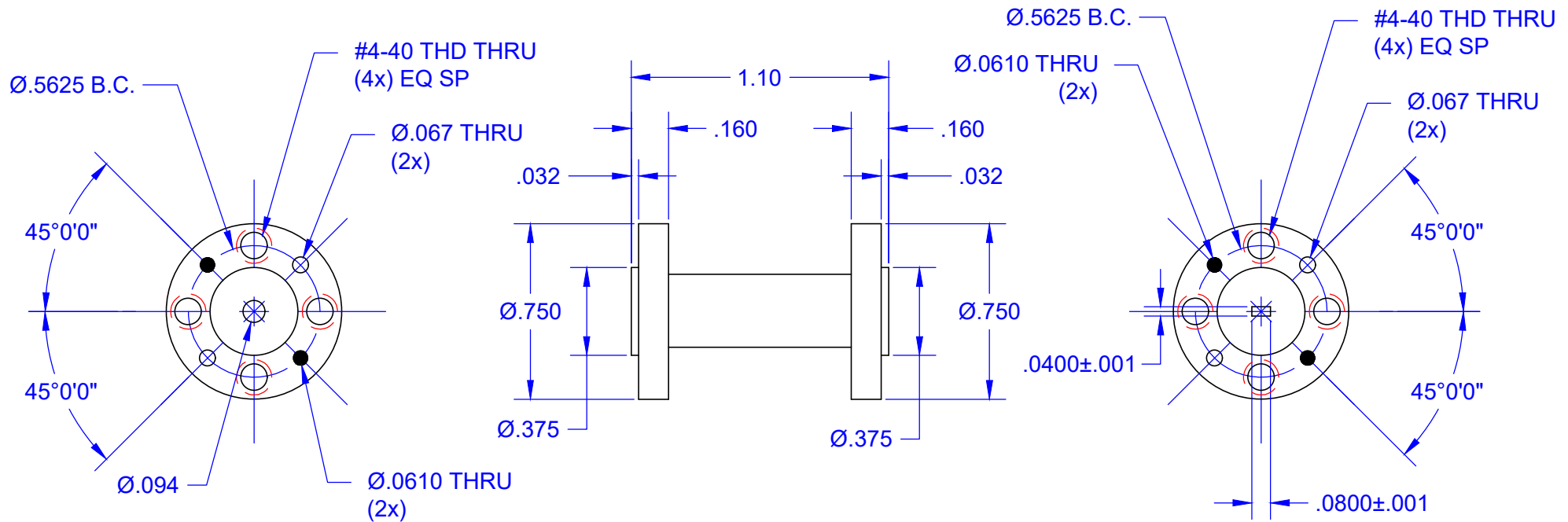

FREQUENCY RANGE (GHz)	CIRCULAR WAVEGUIDE PORT DIAMETER (IN.)
125-140	0.067
112-125	0.075
100-112	0.082
87-100	0.094

--		MATERIAL: 1/2 HARD BRASS		--
QTY	PART NUMBER	DESCRIPTION		ITEM
UNLESS OTHERWISE SPECIFIED ALL SURFACES $\sqrt{32}$		 THIRD ANGLE PROJECTION		<b>Mi-Wave</b> Millimeter Products Inc.  TITLE <h1>284F-387 OUTLINE</h1>
DIMENSIONS ARE IN INCHES TOLERANCES ARE: DECIMALS: $.1234 \pm .0005$ $.123 \pm .005$ $.12 \pm .01$ ANGLES: $\pm .5$ DEGREES				
ALL THREADS TO BE 2A OR 2B		DRAFTING: C.C.		SIZE <b>A</b>
REF DWG# --		APPROVED: M.S.		
		DATE: 6/1/2020		DWG NO <h1>25877</h1>
		SHEET NO. 1	OF 1	